

# Eco | Axis House

Milford, ON

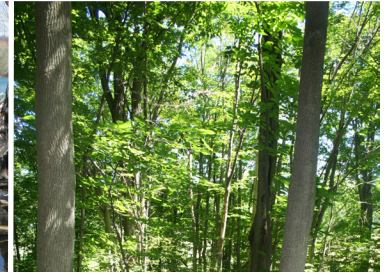

- 1 BREEZEWAY / ENTRY
- 2 DINING
- 3 LIVING
- 4 SCREEN PORCH
- 5 OUTDOOR LIVING
- 6 BUTTERFLY GARDEN
- 7 GUEST BEDROOM
- 8 MASTER BEDROOM
- 9 GARAGE
- 10 BOARDWALK
- 11 SPA & FLAME

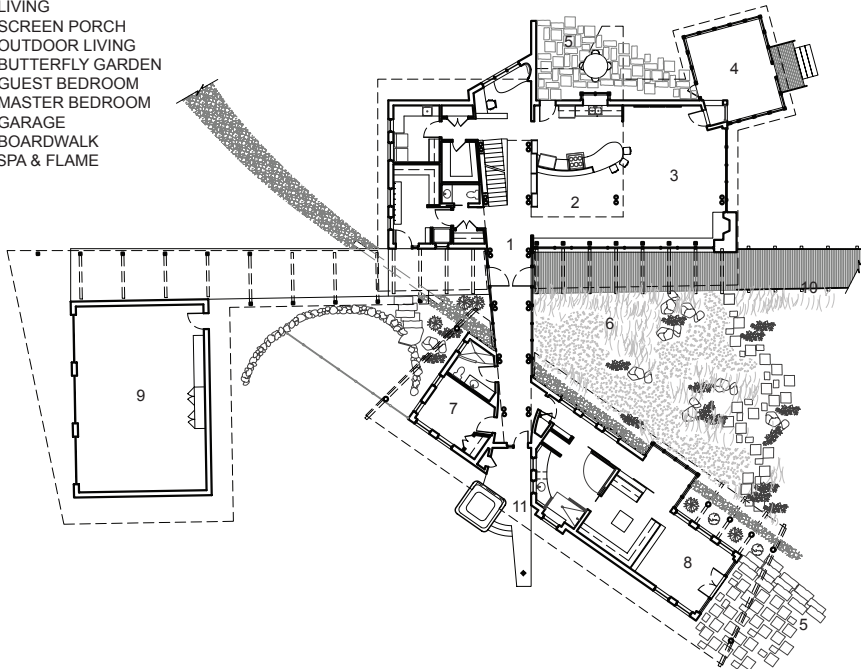

This 25 acres waterfront lot is the setting for seven distinct ecosystems including a gravel beach, a series of ponds and wetlands, an agricultural field and two distinct forests overlying a limestone escarpment. The Client's design criteria included the need to experience the unique natural features of their lot from their house. The resulting design is a series of four interconnected pods, each extending out to one of the natural environments through the use of a raised boardwalk, a row of trees, a trimmed field or a gravel path.

AREA	4,100 sf
BUDGET	Withheld
STATUS	On Hold

## LaPointe

ARCHITECTS

[www.lapointe-arch.com](http://www.lapointe-arch.com)